

# F189 CIN

+135°  
-30°

PA6  
+G.F.

UL94  
HB

RoHS  
COMPLIANT

## INOX

## SOLID CROSS HANDWHEEL WITH THREADED STAINLESS STEEL STUD

**Material:**  
Reinforced polyamide.  
Oils and greases resistant.

**Surface:**  
Satin.

**Colour:**  
Black (RAL 9011).

**Main Insert:**  
Brass blind threaded bush, (thread tolerance 6H).

### SPECIAL REQUESTS:

- It is possible to supply the chian in different lengths or by special design, on request and for quantities.
- It is possible to supply colours as shown in the table on page F-45, on request and for quantities.

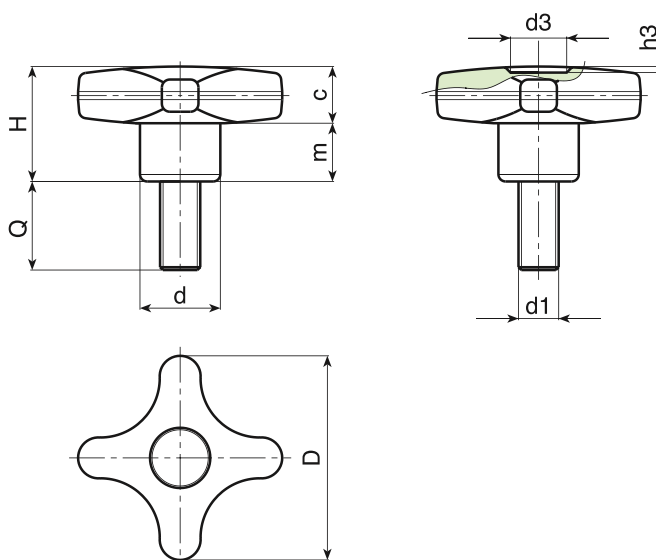
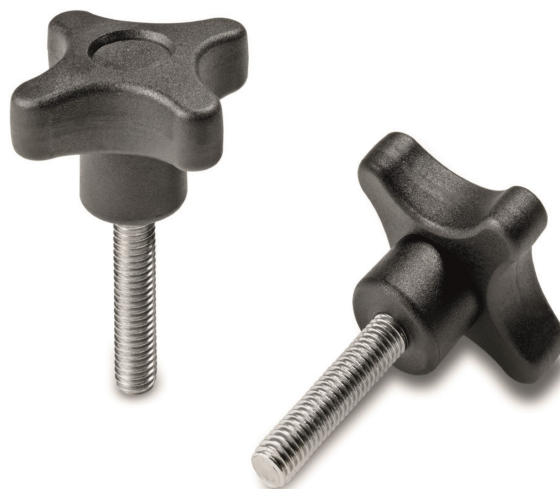

Art.	D	H	d	c	m	d3	h3	LM	d1 6g	Q	g
F18932.TM05X..01CIN	32	23	15	11	11	9	1,5	80	M05	20-40	15-17
F18932.TM06X..01CIN	32	23	15	11	11	9	1,5	80	M06	16-20-30	15-16-17
F18932.TM08X..01CIN	32	23	15	11	11	9	1,5	80	M08	16-20-30	19-21-23
F18932.TM10X2001CIN	32	23	15	11	11	9	1,5	80	M10	20	24
F18940.TM06X..01CIN	40	24,5	17	12	12,5	12	1	80	M06	15-20-40	19,5-20-22
F18940.TM08X..01CIN	40	24,5	17	12	12,5	12	1	80	M08	16-20-30-40	22-24-29-33
F18940.TM10X..01CIN	40	24,5	17	12	12,5	12	1	80	M10	A.R.	-
F18950.TM08X3501CIN	50	29	20	14	15	14,5	1,5	80	M08	35	44
F18950.TM10X..01CIN	50	29	20	14	15	14,5	1,5	80	M10	20-30-40	49-55-61
F18950.TM12X..01CIN	50	29	20	14	15	14,5	1,5	80	M12	A.R.	-
F18960.TM08X..01CIN	60	34	24	15,5	18,5	18	1,5	80	M08	A.R.	-
F18960.TM10X..01CIN	60	34	24	15,5	18,5	18	1,5	80	M10	50	72
F18960.TM12X..01CIN	60	34	24	15,5	18,5	18	1,5	80	M12	40-60	91-103
F18960.TM14X..01CIN	60	34	24	15,5	18,5	18	1,5	80	M14	A.R.	-